



Simple Seal and Multi Seal are special grommets with single hole and multi hole which are simple to use and require no tools for installation. They differ from conventional grommets as they provide IP 67 protection. They can be installed from one side of the panel without any need for installation of lock nuts from the other side as in conventional cable glands. With these grommets necessity of blind stops is removed as in these grommets the opening is always sealed until the membrane is pushed out by the cable. These are suitable for enclosures with wall thickness from 0.5 to 3.5 mm.

Technical Details :	
Material	Thermo Plastic Elastomer
Colour	Black (RAL 9005) Light Grey (RAL 7035)
Temperature Range	-50°C to +125°C
Protection Class	IP 67

SIMPLE SEAL



Size	Cat. No. Light Grey	Cat. No. Black	Panel Cutout Diameter (mm)	Clamping Range (mm)	Standard Pack (pieces)
M16 x 1.5	TSSM16LG	TSSM16B	16.5	5-10	50
M20 x 1.5	TSSM20LG	TSSM20B	20.5	6-13	50
M25 x 1.5	TSSM25LG	TSSM25B	25.5	8-17	50
M32 x 1.5	TSSM32LG	TSSM32B	32.5	12-24	25



Technical Details :	
Material	Thermo Plastic Elastomer
Colour	Black (RAL 9005) Light Grey (RAL 7035)
Temperature Range	-50°C to +125°C
Protection Class	IP 67

MULTI SEAL

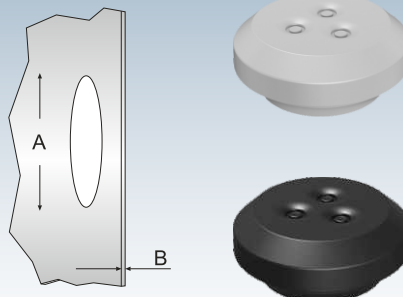

Size	Cat. No. Light Grey	Cat. No. Black	Panel Cutout (A) Diameter (mm)	No. of Holes & Clamping Range (mm)	Standard Pack (pieces)
M20 x 1.5	TSS M20LGM	TSS M20BM	20.5	3 X 4-7	50
M25 x 1.5	TSS M25LGM	TSS M25BM	20.5	3 X 4-9	50
PG 11	TSS P11LGM	TSS P11BM	19	3 X 4-6	50
PG 16	TSS P16LGM	TSS P16BM	23	3 X 4-8	50