



Bulk head mount housings are mounted over cut-outs in the electrical control panels where the conductors approach the inserts fixed inside the housings through the cut-outs.

Technical Details :

| | |
|------------------|-------------------------------|
| Material | Die cast Aluminium alloy |
| Protection Class | IP 66 |
| Voltage | For Inserts upto 500V |
| Gasket | Vinyl Nitrile Elastomer (NBR) |

Panel Cutout

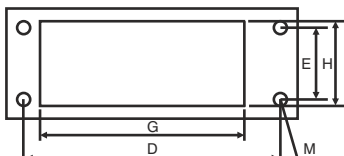

BULK HEAD MOUNT HOUSINGS

WITH 1 LEVER



| Cat. No. | Enclosure Type | Enclosure Size (mm) | D (mm) | E (mm) | G (mm) | H (mm) | M (Ømm) |
|------------|----------------|---------------------|--------|--------|--------|--------|---------|
| W06HB1/B6 | 6B | 44 x 27 | 70 | 32 | 53 | 36 | 4.5 |
| W10HB1/A10 | 10A | 49 x 16 | 70 | 17.5 | 57 | 24 | 3.5 |
| W10HB1/B10 | 10B | 57 x 27 | 83 | 32 | 66.5 | 36 | 4.5 |
| W16HB1/A16 | 16A | 66 x 16 | 86 | 17.5 | 73 | 24 | 3.5 |
| W16HB1/B16 | 16B | 77 x 27 | 103 | 32 | 86.5 | 36 | 4.5 |
| W24HB1/B24 | 24B | 104 x 27 | 130 | 32 | 113 | 36 | 4.5 |
| W32HB1/B32 | 32B | 77 x 62 | 110 | 65 | 87.5 | 76.5 | 5.5 |
| W48HB1/B48 | 48B | 104 x 62 | 148 | 70 | 122.5 | 79.5 | 5.5 |